



# Changing lives now and into the future

*WANTZ Committee and AEIOU Foundation  
helping children with autism  
live their best lives!*

**AEIOU Foundation extends sincere gratitude and heartfelt appreciation to all members of the WANTZ Committee for selecting AEIOU Foundation as 2023 charity beneficiary fundraising efforts.**

In addition, AEIOU is indebted to the WANTZ Committee for the introduction to Lexus Brisbane and their pivotal role of being named Lexus Owners Gift charity beneficiary in 2023. This vital support will go towards an additional \$30,000 donation to invest in 15 iPads with important communication applications installed and will help support children across four centres (Sunshine Coast, Toowoomba, Bald Hills and Gold Coast).

These iPads are so much more than entertainment devices. They will empower AEIOU therapists to determine immediate and ongoing support requirements for each child in our care. The development of communication skills for children with autism can be a gradual and often complex process and the development of functional communication skills requires specialist support and intervention.

We take this moment to recognise and celebrate the achievements of the WANTZ Committee.

Established in 2003 by a group of friends in response to a need in the community to help in a very practical way. From 2003 to 2022 the Wantz Committee have raised over \$2.2 million for a variety of worthy causes.

On behalf of all at AEIOU Foundation including the children and the families we serve. Thank you, we are sincerely grateful for everything that the Wantz Committee achieves in the community and for your support of AEIOU.

We applaud you.



# Funding Proposal to WANTZ Committee



AEIOU Foundation actively pursues philanthropic funding (as well as donated goods and services) to support the effective delivery of our world class early intervention service.

It is proposed that the much-needed funds donated by The Wantz Committee in 2023 are utilised to help AEIOU establish a brand-new centre to service families in Townsville, North Queensland.

This exciting and much anticipated new centre will not only increase AEIOU's capacity to deliver our early intervention service by an additional 30%. It will also future proof the delivery of the AEIOU program for the next four decades.

The Wantz Committee's generous support in this initiative will change lives now and into the future. Leaving a legacy for children attending AEIOU centres now and for those children yet to be born who will need support in the future.

## AEIOU Townsville Centre

The current centre (opened in 2008) provides opportunities for 18 children. The centre is at capacity and demand for autism early intervention is rising. The centre is tired, dated and maligned with serious issues that contribute to negative perception with AEIOU staff, families, and the community.

The AEIOU Foundation has purchased land in Idalia, Townsville and in partnership with Buchan Group Architects and Hutchinson Builders, has designed and will build a new autism facility for the Townsville community. The new AEIOU Townsville centre will be a state-of-the-art 30 placement centre with three early intervention classrooms, a motor skills therapy room, consulting/telehealth rooms, a community meeting/training facility, dedicated research rooms, external learning environments and playgrounds. The existing centre in Kirwan, will be decommissioned.

Vital support is needed to refurbish and outfit the vital Play to Learn Area.

# Play to learn area

Play is a vital component of children's development and has been recognised as a human right for every child by the Office of the United Nations High Commissioner for Human Rights. Play has an integral role in the development of social, cognitive, symbolic and linguistic skills – all vital to the skills development under the evidence based AEIOU curriculum.

Anticipated costings of the new Townsville Centre Play to Learn Area:

Soft fall / artificial turf	\$55,000
Shade Sails x 3	\$30,000
Playground Equipment	\$50,000
Playground Equipment Installation	\$15,000

**Total Costings Play to Learn Project \$150,000**

Note:

- *Costings above may increase between now and implementation – acquittal report will be provided on completion.*
- *Costings above exclude - soft landscaping (gardens and real turf, fencing, garden shed and outdoor decking).*
- *If the Wantz Committee should raise in excess of \$150,000 – those funds could support the soft landscaping as outlined above.*

## Wantz Committee Play to Learn Area Recognition:

The Wantz Committee support of the new Townsville Centre will be recognised onsite on the Supporter Honor Board.

In addition, one or more members will be officially invited to the Opening Ceremony.



Canberra centre - new purpose built playground

SITE PLAN

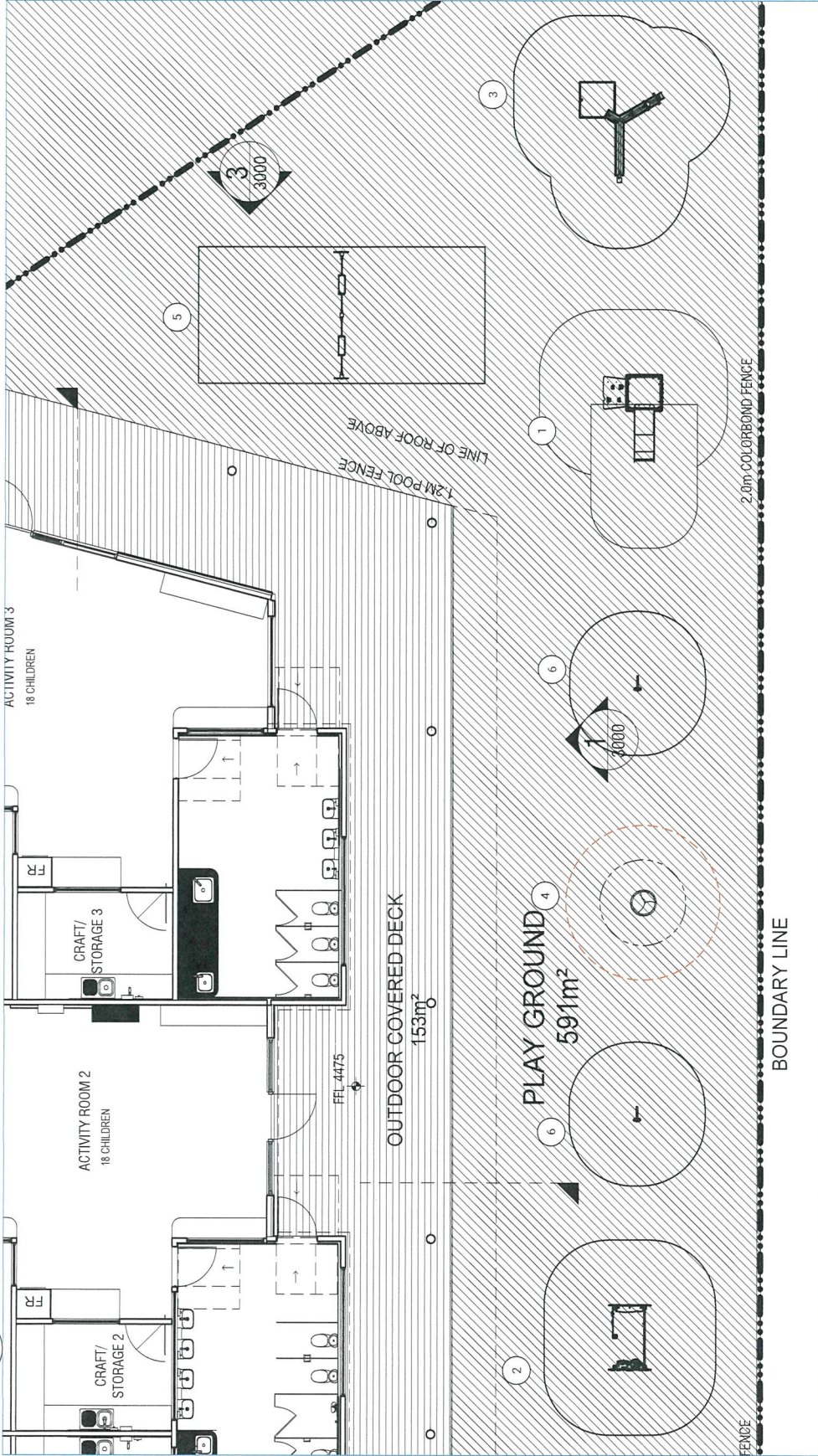

Products

Item	Label	FHOF
1	Vinci Unit WD1403	0.90m
2	Vinci Police Car WD1430	1.10m
3	Vinci Water Play WP2858	<0.60m
4	Playworld Spinning Cup ZZX006S	0.61m
5	Vinci Swing S10511	0.99m
6	Talking Tubes - 808	<0.60m

**PlayRope**  
design · build · play

**Playground Equipment**

Please review all supplied drawings and verify all products, quantities, colours, finishes and dimensions is correct and comply with the requirement of the client. Please sign and date as correct, scan and return by email.

Print name : \_\_\_\_\_ Date : \_\_\_/\_\_\_/2022  
Signature : \_\_\_\_\_

Legend:

- 1 Circulation Area
- 2 Training Space EN16630:2017
- 3 Movement Space EN16630:2017

Notes:

The information contained in this document is prepared for the client's use only. PlayRope Pty Ltd is not responsible for the accuracy of the information provided. The information is provided on an 'as is' basis and is not intended to constitute a contract. PlayRope Pty Ltd is not liable for any loss or damage, including consequential, special, or exemplary damages, arising from the use of this information. The information is provided for the client's use only and is not intended to constitute a contract. PlayRope Pty Ltd is not liable for any loss or damage, including consequential, special, or exemplary damages, arising from the use of this information.

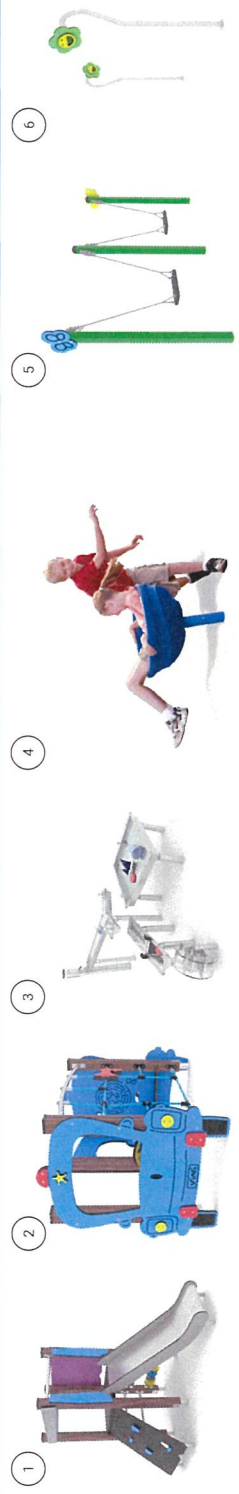

Project	AEIOU Childcare / Townsville Concept Content	Client	Buchan Group	Drawing No	DR221129XX	Sheet	1	Revision	2	Date	29-Nov-22	Checked by	I.G	Drawn by	DM	Rev No	1	Rev Date	11-11-22	BDM	CAD
																	2	17-11-22			



# Thank YOU

AEIOU Foundation welcomes the caring support of our community to raise awareness and much-needed funds so we can reach even more children with autism to live their best lives. Thank you.

## Contact details:

Alan Smith, CEO

✉ [alan.smith@aeiou.org.au](mailto:alan.smith@aeiou.org.au)

📞 0438 553 443

Julie Mullen, Fundraising Manager

✉ [julie.mullen@aeiou.org.au](mailto:julie.mullen@aeiou.org.au)

📞 0448 072 282